



### Special Features

- With double flushing ports.
- Suitable with flanged, pancake or inline diaphragm seals.
- Available in all exotic material grades.

### Application

- The flushing ring is designed to be sandwiched between the process flange & the diaphragm seal.
- Material collected in front of diaphragm can be flushed out through the flushing ports.

### Specifications

**Standard Version** (Compatible Baumer Models : DI, DJ, DK & DM)

Flange Size	:	½" to 5" as per ANSI B 16.5
Material	:	AISI 316 SS
Number of ports	:	Two
Port Connection	:	1/4" NPT (F) with Male plug
Sealing Face	:	Suitable to Raised Face of Flange

### Dimensions - Standard Version

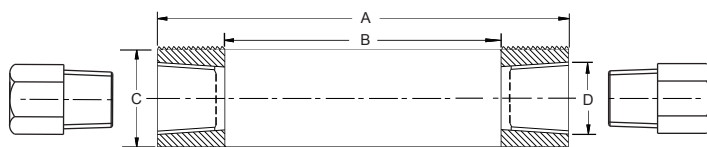

### For flange type diaphragm seals

Flange Size	Class	A	B	C	D
½"	150 # to 600 #	35	12	30	1/4" NPT or ½" NPT (F)
¾"	150 # to 600 #	43	20	30	
1"	150 # to 600 #	51	25	30	
1½"	150 # to 600 #	73	43	30	
2"	150 # to 600 #	92	62	30	
3"	150 # to 600 #	127	92	30	
4"	150 # to 600 #	157	92	30	1/4" NPT (F)
5"	150 # to 600 #	185.5	126	30	

Note: other sealing face and higher pressure rating flushing rings on request. Please specify.

Notes :

- Drawings are not to scale.
- All Dimensions are in mm.

### How To Order

Basic Model											EE	
Code												
Optional Extras												
Flange Size (As per ANSI B 16.5) (* Consult factory for drawings of these Baumer models)											X OR XX	
1/2"	3/4"	1"	1 1/2"	2"	3"	4"	5"	D0*	DB*	DI*		
Flange Rating (Do not select if DA or DB required)												
150	300	400	600								XXX	
Sealing Face												
A2	Raised Face (Standard)			A3	Flat Face							XX
Flushing Ring Material												
KM	AISI 316L SS			KV	Carbon steel			KX	Titanium			
KY	Hastelloy C			KW	Monel			CT	AISI 316 SS (Standard)			
Flushing Ports ( with two male plugs)											XX	
VF	1/4" NPT (F) (Standard)			VD	1/2" NPT (F)							
Options	GH	Material test certificates*			TF	Conformity as per NACE Standard						XX

\* Material test certificates will be provided for wetted parts only with chemical composition testing. For others, please consult factory.

**Ordering example:** EE . X OR XX . XXX . XX . XX . XX . XX

Note : Specifications and dimensions given in this product catalogue represents the state of engineering at the time of printing.

Modifications may take place and materials specified may be replaced by others without prior notice.